

FACTORY-APPLIED POLYURETHANE FACING  
(NUMBER OF BELLOWS VARIES  
WITH NOMINAL MATERIAL SIZE)

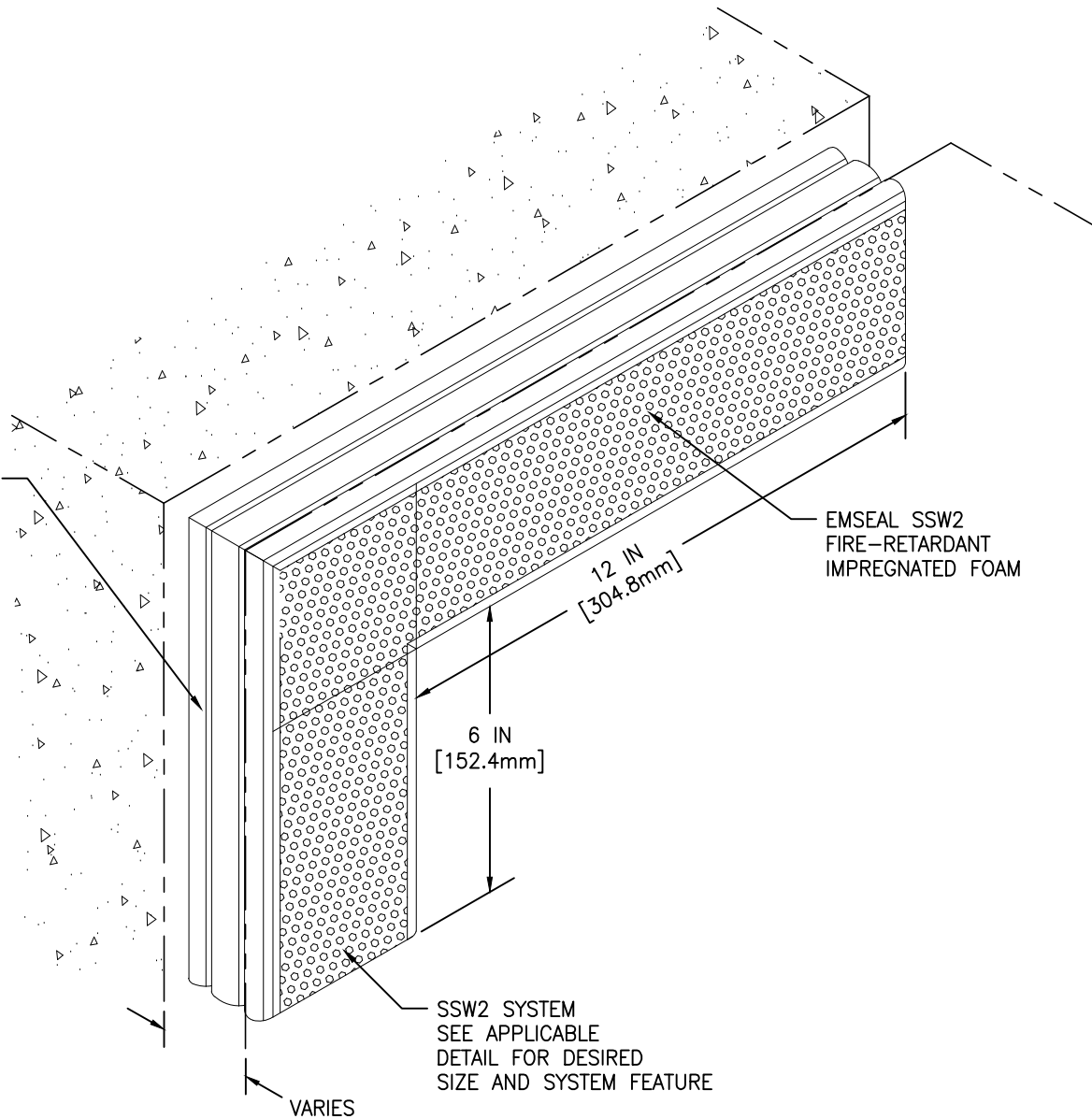

EMSEAL SSW2  
FIRE-RETARDANT  
IMPREGNATED FOAM

12 IN  
[304.8mm]

6 IN  
[152.4mm]

SSW2 SYSTEM  
SEE APPLICABLE  
DETAIL FOR DESIRED  
SIZE AND SYSTEM FEATURE

VARIES

MOVEMENT:  $\pm 50\%$  (TOTAL 100%) OF NOMINAL MATERIAL SIZE

## EMSEAL JOINT SYSTEMS LTD.

### EMSHIELD SSW2- UNIVERSAL 90 DOWNTURN -TYPICAL

THIS DOCUMENT CONTAINS INFORMATION OF A CONFIDENTIAL NATURE AND IS PROPRIETARY TO EMSEAL JOINT SYSTEMS LTD. ANY UNAUTHORIZED USE WILL BE PROSECUTED. THIS DRAWING IS PROTECTED BY COPYRIGHT, THE RIGHT TO REPRODUCE IN ANY FORM BEING THE EXCLUSIVE RIGHT OF EMSEAL JOINT SYSTEMS LTD. ANY UNAUTHORIZED REPRODUCTION WHETHER IN TWO OR THREE DIMENSIONS WILL BE PROSECUTED. © 2014 EMSEAL JOINT SYSTEMS LTD.

DRAWN BY: ORK	DATE: 2016/09/07	SCALE: N.T.S.	SHEET No: 1 OF 1
------------------	---------------------	------------------	---------------------

PART NUMBER:  
SSW2\_3\_VTRAN\_U\_90\_DOWNTURN\_TRANS\_TYPICAL