

**Assembly Rating — 2 Hr**  
**Joint Width — 6 In. Max**

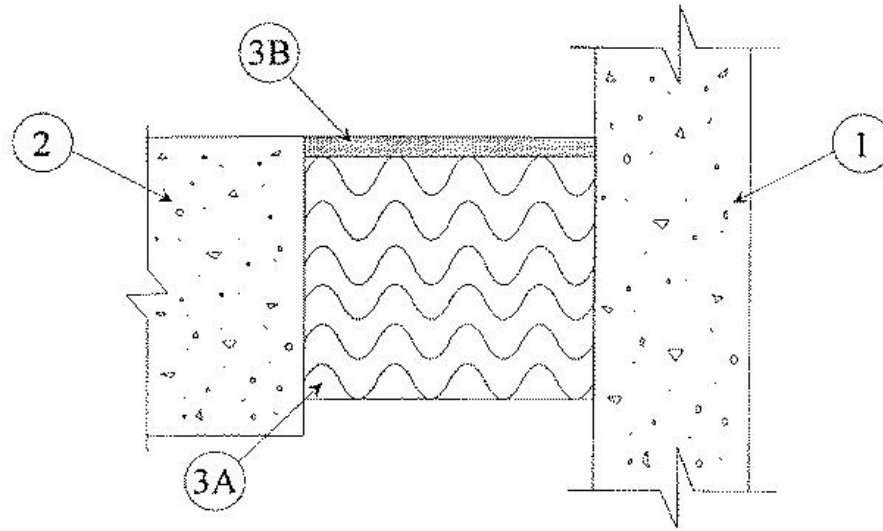

1. **Wall Assembly** — Min 4-1/2 in. thick reinforced lightweight or normal weight (100-150 pcf) structural concrete. Wall also may be constructed of any UL Classified **Concrete Blocks\***.

See Concrete Blocks (CAZT) category in the Fire Resistance Directory for names of manufacturers.

2. **Floor Assembly** — Min 4-1/2 in. thick reinforced lightweight or normal weight (100-150 pcf) structural concrete.

3. **Joint System** — Max width of joint is 6 in. The joint system shall consist of the following:

A. **Packing Material** — Min 3-3/4 in. thickness of min 4.0 pcf mineral wool batt insulation tightly packed into opening as a permanent form. Packing material to be recessed from top surface of floor to accommodate the required thickness of fill material.

B. **Fill, Void or Cavity Material\*** — Min 1/4 in. thickness of fill material applied within the joint, flush with top surface of floor.  
**RECTORSEAL** — [Metacaulk 835+](#)

\*,+ Indicates such products shall bear the UL or cUL Certification Mark for jurisdictions employing the UL or cUL Certification (such as Canada), respectively.

Reprinted from the Online Certifications Directory with permission from UL. ©UL LLC